

STRATA PLAN
EPS4547

KEY	BOTANICAL NAME	PLANT LIST COMMON NAME	QTY.	SIZE	SPACING	REMARKS
	ACER PALMATUM OSAKAZUKI	GREEN JAPANESE MAPLE	2	6 CM. CAL.	AS SHOWN	B. & B.
	AZALEA JAPONICA (VARIOUS)	JAPANESE AZALEA	18	#3 POT	90 CM. O.C.	
	ABELIA 'EDWARD GOWCHER'	EDWARD GOUCHER ABELIA	2	#3 POT	90 CM. O.C.	
	BUXUS MACROPHYLLA 'WINTER GEM'	ASIAN BOXWOOD	92	#3 POT	45 CM. O.C.	
	HYDRANGEA MACROPHYLLA 'NIKKO BLUE'	HYDRANGEA	4	#3 POT	90 CM. O.C.	
	MEDIUM RHODODENDRON (VARIOUS)	RHODODENDRON	21	#3 POT	90 CM. O.C.	
	SYRINGA VULGARIS 'MICHEL BUCHNER'	LILAC	8	#3 POT	90 CM. O.C.	
	PRUNUS LAUROCERASUS 'OTTO LUYKEN'	OTTO LUYKEN LAUREL	66	#3 POT	70 CM. O.C.	
	THUJA OCCIDENTALIS 'SMARAGD'	EMERALD ARBORVITAE	16	1.50 METERS	70 CM. O.C.	

- NOTES / GENERAL**
- PLANT SIZES IN THIS LIST ARE SPECIFIED ACCORDING TO BC LANDSCAPE STANDARD "LATEST EDITION". CONTAINER SIZES ARE SPECIFIED AS PER "ONTA STANDARDS" BOTH PLANT SIZE AND CONTAINER SIZE ARE THE MINIMUM ACCEPTABLE SIZES. SEARCH AND REVIEW, MAKE PLANT MATERIAL AVAILABLE FOR OPTIONAL REVIEW BY "LANDSCAPE ARCHITECT" AT SOURCE OF SUPPLY. AREA OF SEARCH TO INCLUDE LOWER MAINLAND AND FRASER VALLEY. "SUBSTITUTIONS" MUST OBTAIN WRITTEN APPROVAL FROM THE "LANDSCAPE ARCHITECT" PRIOR TO MAKING ANY SUBSTITUTIONS TO SPECIFIED MATERIAL. UNAPPROVED SUBSTITUTIONS WILL BE REJECTED. ALLOW A MINIMUM OF FIVE WORKING DAYS PRIOR TO DELIVERY FOR REQUEST TO SUBSTITUTE. SUBSTITUTIONS ARE SUBJECT TO "B.C. LANDSCAPE STANDARD"
 - ALL PLANT MATERIAL MUST BE PROVIDED FROM CERTIFIED "DISEASE FREE" NURSERY. ALL PLANT MATERIAL MUST CONFORM TO THE LATEST EDITION OF THE "BC LANDSCAPE STANDARD". PROVIDE CERTIFICATION UPON REQUEST. ALL LANDSCAPING AND LANDSCAPE MATERIALS TO CONFORM TO THE LATEST EDITION OF THE BCNA/BCSLA "LANDSCAPE STANDARDS"
 - MIN. GROWING MEDIUM DEPTHS OVER PREPARED SUBGRADE SHALL BE:

LAWN AREAS	300 mm
GROUND COVER AREAS	450 mm
SHRUB AREAS	450 mm
TREE PITS	300 mm AROUND ROOT BALL
 - GROWING MEDIUM SHALL HAVE PHYSICAL AND CHEMICAL PROPERTIES AS DESCRIBED IN THE STANDARDS FOR LEVEL 2 AND LEVEL 3 AREAS, EXCEPT FOR AREAS OVER STRUCTURES WHERE THE MEDIUM SHALL CONFORM TO THE REQUIREMENTS FOR LEVEL 1 APPLICATIONS. PROCESSING AND MIXING OF GROWING MEDIUM COMPONENTS SHALL BE DONE OFF-SITE USING A MECHANIZED SCREENING PROCESS. PROPOSED GROWING MEDIUM SHALL BE TESTED BY A RECOGNIZED LABORATORY. THE CONTRACTOR SHALL GUARANTEE THAT THE SOIL SUBMITTED FOR TESTING IS A REPRESENTATIVE SAMPLE TAKEN FROM THE SOIL THAT WILL BE USED AT THE SITE.
 - ON-SITE OR IMPORTED SOILS SHALL SATISFY THE REQUIREMENTS OF THE STANDARDS FOR GROWING MEDIUM. SOILS SHALL BE VIRTUALLY FREE FROM SUBSOIL, WOOD INCL, WOODY PLANT PARTS, WEED OR REPRODUCTIVE PARTS OF WEEDS, PLANT PATHOGENIC ORGANISMS, TOXIC MATERIALS, STONES OVER 30 MM AND FOREIGN OBJECTS.
 - ALL PLANTING BEDS SHALL RECEIVE MIN. 50 MM BARK MULCH.
 - PLANT SPECIES AND VARIETIES MAY NOT BE SUBSTITUTED WITHOUT THE APPROVAL OF THE LANDSCAPE ARCHITECT.
 - THE CONTRACTOR SHALL GUARANTEE ALL MATERIALS AND WORKMANSHIP FOR A PERIOD OF ONE (1) FULL YEAR FROM THE DATE OF FINAL ACCEPTANCE, UNLESS OTHERWISE SPECIFIED. ALL PLANT MATERIAL NOT SURVIVING, OR IN POOR CONDITION DURING THE GUARANTEE PERIOD SHALL BE REPLACED BY THE CONTRACTOR AT NO EXTRA COST TO THE OWNER.
 - THE CONTRACTOR SHALL CLEAR AWAY FROM THE SITE ALL RUBBISH AS IT ACCUMULATES, AND SHALL, AT THE COMPLETION OF THE WORK, LEAVE THE WORK AND THE SITE THEREOF IN A CLEAN AND PRESENTABLE CONDITION, FREE FROM ALL OBSTRUCTIONS.

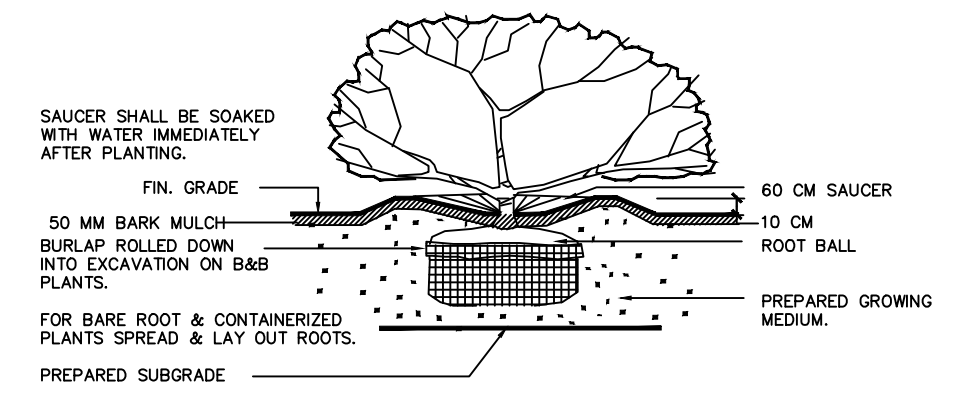

PLANTING DETAIL - SHRUBS & GRD. COVER PLANTS
SECTION N.T.S.

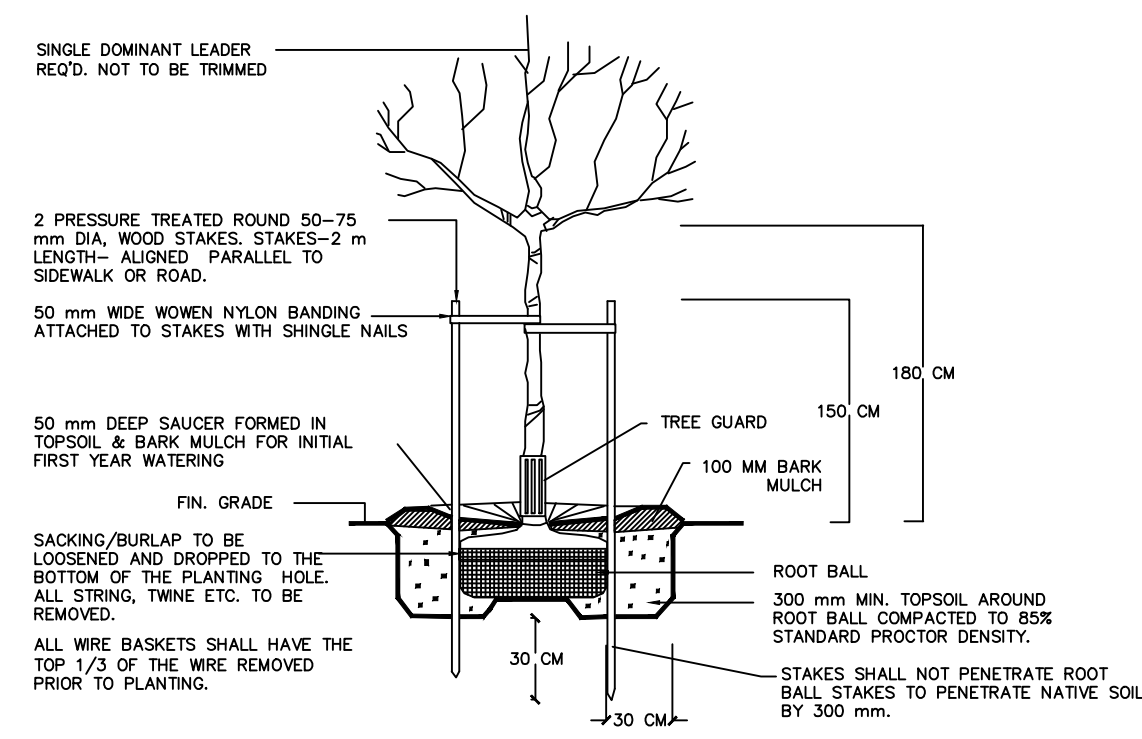

TREE PLANTING DETAIL
SECTION N.T.S.

MAGLIN™

MLB450W

MATERIALS: Bench frame is made from H.S. steel tube and flat bar. The seat and back employ wood slats.

FINISH: All steel components are protected with E-Coat rust proofing. The Maglin Powdercoat System provides a durable finish on all metal surfaces. Wood slats are finished with penetrating sealers.

INSTALLATION: The bench is delivered pre-assembled. Holes (Ø17) are provided in each foot for securing to base.

TO SPECIFY: Select MLB450W
 Choose:
 - Use (MLB450W)
 - Recycled Plastic (MLB450R)
 - Recycled Plastic select color
 - Powdercoat Color

COMPLEMENTARY PRODUCTS:
 - MLB450SW
 - MLWR450-20W
 - MLP450W

DIMENSIONS:
 Height: 38.00" (91.44 cm)
 Length: 70.00" (177.8 cm)
 Depth: 24.63" (62.7 cm)
 Seat: 18.00" (45.7 cm)
 Weight: 151 lbs (68kg)

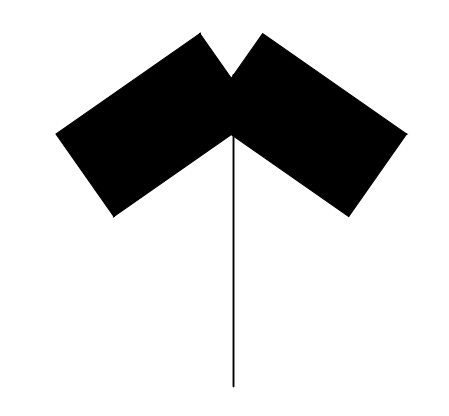

DATE	REVISIONS	NO.
dec/20	ADP COMMENTS	4
nov/20	NEW SITE PLAN	3
DEC/18	NEW SITE PLAN	2
NOV/18	NEW SITE PLAN	1

C.KAVOLINAS & ASSOCIATES INC.
BCSLA CSLA
2462 JONQUIL COURT
ABBOTSFORD, B.C.
V3G 3E8
PHONE (604) 857-2376

CLIENT
MR. VIPAN SHARMA
CENTURY 21 COASTAL REALTY LTD.
SUITE #105
7928 128th STREET
SURREY, B.C.
V3W 4E9

TITLE
PLAN VIEW
LANDSCAPE PLAN
PROPOSED
TOWNHOUSE DEVELOPMENT
20172 - 53A AVENUE
LANGLEY, B.C.

SCALE	1:150	DATE	OCT/18
DRAFT	CHK'D	ENG.	CHK'D
APPR'D	AS BUILT		

PRINTED
JOB No.
DRAWING No.
L-1